

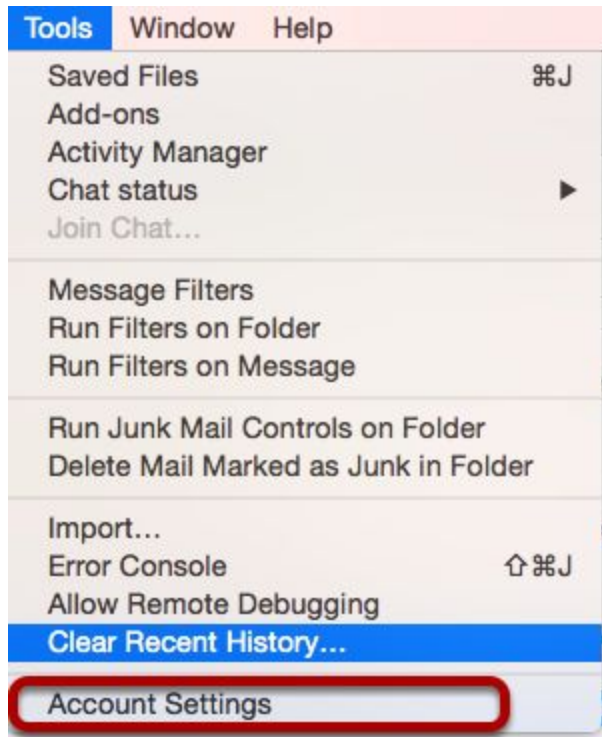

Thunderbird Email Setup

This tutorial will walk you through the configuration of email using Thunderbird. For this tutorial, we are using Thunderbird 45 on Mac. If you are using a different version or operating system, these instructions may differ.

Step 1: Open Account Settings



Launch Thunderbird, click on **Tools**, and select **Account Settings**.

Step 2: Add Mail Account

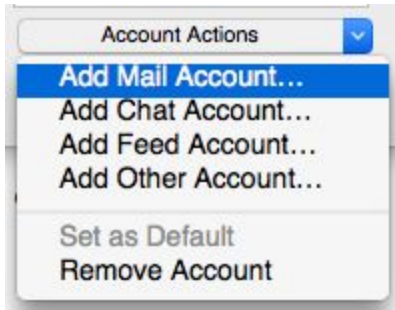

Under **Account Actions**, click **Add Mail Account...**

Step 3: Enter Account Information

Your name: Your name, as shown to others

Email address:

Password:

Remember password

Enter the following information:

Your Name:

This is the name that will appear on all outgoing mail from the account.

Email Address:

Enter your full email address.

Password:

Enter the password for your email address.

Click **Continue**.

Step 4: Enter Account Information

Your name: Your name, as shown to others

Email address:

Password:

Remember password

⚠ Thunderbird failed to find the settings for your email account.

	Server hostname	Port	SSL	Authentication	
Incoming:	IMAP <input type="button" value="v"/>	mail.hostedemail.com <input type="button" value="v"/>	993 <input type="button" value="v"/>	SSL/TLS <input type="button" value="v"/>	Autodetect <input type="button" value="v"/>
Outgoing:	SMTP <input type="button" value="v"/>	mail.hostedemail.com <input type="button" value="v"/>	465 <input type="button" value="v"/>	SSL/TLS <input type="button" value="v"/>	Autodetect <input type="button" value="v"/>
Username:	Incoming: <input type="text" value="user@example.com"/>	Outgoing: <input type="text" value="user@example.com"/>			

Enter the following information:

Incoming Protocol: IMAP or POP3 as per your preference. We recommend IMAP.

Server Hostname: mail.hostedemail.com

Port 993 (incoming IMAP) 995 (Incoming POP3)465 (outgoing)

SSL:

SSL / TLS

Authentication:

Auto-detect

Username:

Your full email address

Once you are finished, click **Re-Test**. Thunderbird will test your account settings and account creation will be complete.